



THE  
MILLHOUSE  
P A I S L E Y

# CONTENTS

---

|                            |           |                        |           |
|----------------------------|-----------|------------------------|-----------|
| COME HOME TO THE MILLHOUSE | <u>05</u> | APARTMENT 15           | <u>36</u> |
| A VIEW OF HISTORY          | <u>07</u> | APARTMENT 16           | <u>37</u> |
| A ROOM FOR YOU             | <u>09</u> | APARTMENT 17           | <u>38</u> |
| A PLACE TO RELAX           | <u>11</u> | APARTMENT 18           | <u>39</u> |
| A PLACE TO LIVE            | <u>13</u> | APARTMENT 19           | <u>40</u> |
| NEW MEETS OLD              | <u>15</u> | APARTMENT 20           | <u>41</u> |
| HISTORY ON YOUR DOORSTEP   | <u>17</u> | APARTMENT 21           | <u>42</u> |
| SPECIFICATIONS             | <u>19</u> | APARTMENT 22           | <u>43</u> |
| PLOT LOCATOR               | <u>21</u> | APARTMENT 23           | <u>44</u> |
| APARTMENT 01               | <u>22</u> | APARTMENT 24           | <u>45</u> |
| APARTMENT 02               | <u>23</u> | APARTMENT 25           | <u>46</u> |
| APARTMENT 03               | <u>24</u> | APARTMENT 26           | <u>47</u> |
| APARTMENT 04               | <u>25</u> | APARTMENT 27           | <u>48</u> |
| APARTMENT 05               | <u>26</u> | APARTMENT 28           | <u>49</u> |
| APARTMENT 06               | <u>27</u> | APARTMENT 29           | <u>50</u> |
| APARTMENT 07               | <u>28</u> | APARTMENT 30           | <u>51</u> |
| APARTMENT 08               | <u>29</u> | APARTMENT 31           | <u>52</u> |
| APARTMENT 09               | <u>30</u> | APARTMENT 32           | <u>53</u> |
| APARTMENT 10               | <u>31</u> | APARTMENT 33           | <u>54</u> |
| APARTMENT 11               | <u>32</u> | APARTMENT 34           | <u>55</u> |
| APARTMENT 12               | <u>33</u> | THE MILLHOUSE LOCATION | <u>56</u> |
| APARTMENT 13               | <u>34</u> | CONTACT DETAILS        | <u>57</u> |
| APARTMENT 14               | <u>35</u> |                        |           |



# THE MILLHOUSE

BRIDGE STREET, PAISLEY







# COME HOME TO THE MILLHOUSE

---

The Millhouse is a new and stylish development of 34 contemporary two and three-bedroom apartments for Paisley. Set over five storeys, our stunning apartments occupy a prime location in the historic town.

Balconies and penthouse apartments overlook the White Cart Water with some enjoying panoramic views of Paisley's Victorian Town Hall and its iconic Abbey.

Our collection of apartments include modern appliances and luxury finishes throughout with kitchens designed by Howdens and bathrooms from luxury brand, Porcelanosa.





## A VIEW OF HISTORY

---

The Millhouse offers modern living in the heart of Paisley centre with excellent transport links to connect commuters to Glasgow city centre. The new development is in walking distance from Gilmour Street Train Station and bus links as well as being in close proximity to Glasgow International Airport.

With only 34 apartments in the collection, this is a truly unique opportunity to acquire and live at The Millhouse. Many of the luxury apartments come with balconies to the front with spectacular views over to Paisley's iconic Abbey and the Town Hall as well as views to the Anchor Mill.

The Millhouse is delighted to also bring new café/restaurants to the bustling town, located on the ground floor, and adding to the local amenities including shops, bars, cafes and sporting venues, already on your doorstep.





## A ROOM FOR YOU

---

Contemporary living spaces serve to complement modern living with stunning views over Paisley.

Each of the apartments are designed with welcoming neutral décor, ready for you to add your style and personality.

Personalising your home can be made easier with the help of our dedicated Customer Liaison Manager, who can discuss a choice of upgrades to personalise your new home.





## A PLACE TO RELAX

---

Our collection of apartments include bathrooms and en-suites designed by luxury brand, Porcelanosa. We will work with you to create your dream bathroom with a choice of tiling to choose from.







# A PLACE TO LIVE

We will work with leading kitchen provider Howdens to provide stunning designer kitchens from its Greenwich range.

Their sleek-looking contemporary style is available in a choice of colours including popular dove greys, whites and gloss finishes.

Our team will be on hand to help you make the right choice and to walk you through the process every step of the way.







# NEW MEETS OLD

---

Whether you are a first-time buyer or you are downsizing, there is no better location in the town for modern living than The Millhouse.

Selected plots are available for parking on request from our sales agent and there is parking in the surrounding areas with residents eligible for a free permit, on request.

Attractive communal spaces and modern entry to maintain building security are maintained by the appointed factor.



# HISTORY ON YOUR DOORSTEP

Rising from the banks of the White Cart Water, The Millhouse enjoys spectacular views over Paisley's iconic Abbey, dating back to the 12th century, and is located adjacent to the town's historic Anchor Mill.





# SPECIFICATIONS

---

## INTERIOR FINISHES

Figured flat faced veneer doors.  
Chrome Designer ironmongery.  
Satin wood finish to skirting and facings.  
Decoration in a neutral palette.

## WALL AND FLOOR FINISHES

Quality designer ceramic wall tile and flooring by Porcelanosa with a contemporary finish to bathrooms and en suites.  
Feature wall in bathrooms.

## KITCHENS

Subject to timing, a choice of fully fitted kitchens by kitchen designer Howdens are available to early purchasers, and, as standard, feature:  
Quality contemporary flat panelled kitchens.  
Decoration in a neutral palette.  
Induction hob.  
Stainless steel hood.  
Stainless steel oven.  
Stainless steel sink, drainer and monobloc chrome tap.  
Integrated washer dryer.  
Integrated dishwasher.  
Integrated fridge/freezer.

## BATHROOMS

Contemporary white ceramic sanitary ware.  
Contemporary chrome filler taps.  
Large format, square edged, feature wall tiling (full height to wet areas).  
Decoration in a neutral palette.  
Shower over bath.  
Mirror on wall above vanity unit/whb/wc.

## EN SUITES

Contemporary white ceramic sanitary ware.  
Electric charge shaver point.  
Clear glass and chrome shower enclosure.  
Thermostatic chrome valve shower with large wall mounted shower head.  
Large format, square edged, feature wall tiling (full height to wet areas).  
Decoration in a neutral palette.

## BUILT IN WARDROBES

Built in double wardrobes with chrome hanging rail and top shelf to master bedroom.

## ELECTRICAL

Recessed led lighting to kitchen, ensuites and bathrooms.  
Pendant light fittings to lounge, hall and bedrooms.  
Sky/digital/cable connection points in lounge and master bedroom for customer connection.  
Telephone points in lounge and master bedroom.  
Heat and/or smoke detection system including CO and CO2 detectors.

## HEATING AND SERVICES

Gas fired combination boiler central heating to each apartment.  
Thermostatically controlled radiators.  
Chrome towel radiator to bathroom and en suite.

## SECURITY FEATURES

Audio security door entry system.  
Electronic security alarm to all ground floor apartments.  
Security dusk till dawn lighting to external areas.  
Lift access to all floors.



The details contained in this brochure are believed to be correct at the time of publication (September 2021). However, their accuracy is not guaranteed, and they do not form part of a contract. It should be noted that area and room measurements are approximate only, may be taken at the longest and widest points of any rooms and the 3D floorplan illustrations may not be to scale. Images and CGIs are for guidance only and are of a typical apartment within the development. Kitchen and bathroom choices are available subject to the build schedule and the specification listed is subject to change at the developers' discretion.





# PLOT LOCATOR

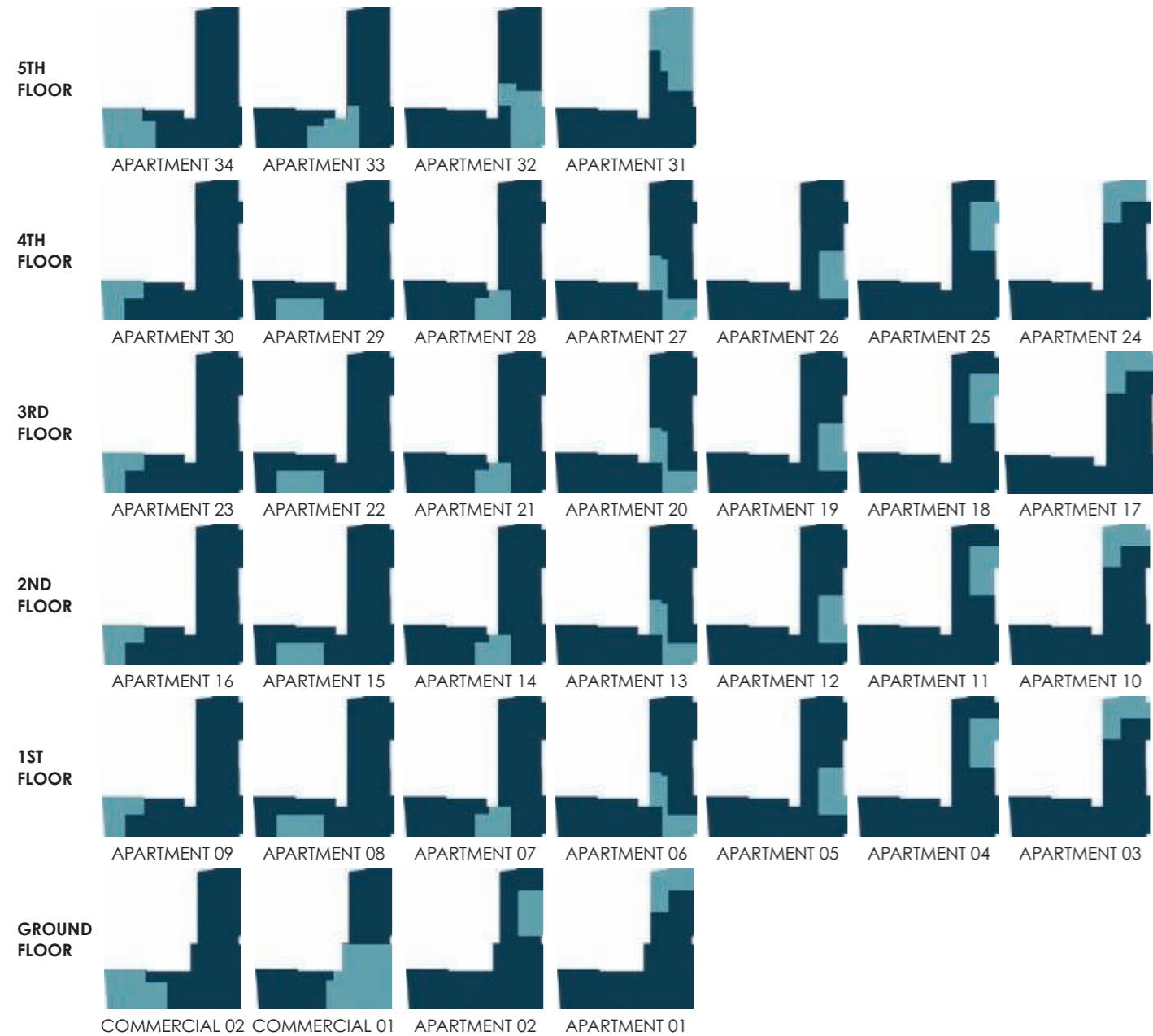

# APARTMENT 01



## TWO BEDROOM, GROUND FLOOR WITH TERRACE

800 sq ft | 74.3 sq m

|                       |               |               |
|-----------------------|---------------|---------------|
| <b>KITCHEN/LOUNGE</b> | 19'1" x 16'8" | 581cm x 512cm |
| <b>BATHROOM</b>       | 9'5" x 6'3"   | 290cm x 193cm |
| <b>BEDROOM 1</b>      | 14'5" x 9'5"  | 443cm x 290cm |
| <b>ENSUITE</b>        | 7'4" x 4'9"   | 226cm x 150cm |
| <b>BEDROOM 2</b>      | 12'0" x 9'5"  | 366cm x 290cm |
| <b>TERRACE</b>        | 17'10" x 3'7" | 546cm x 113cm |

- Measurement taken at longest and widest point
- Any areas or measurements are approximate



BRIDGE STREET



# APARTMENT 02



## TWO BEDROOM, GROUND FLOOR WITH TERRACE

706 sq ft | 65.6 sq m

|                       |               |               |
|-----------------------|---------------|---------------|
| <b>LOUNGE/KITCHEN</b> | 19'1" x 11'8" | 581cm x 360cm |
| <b>BATHROOM</b>       | 9'3" x 5'6"   | 284cm x 170cm |
| <b>BEDROOM 1</b>      | 13'7" x 10'8" | 417cm x 329cm |
| <b>ENSUITE</b>        | 7'7" x 5'4"   | 236cm x 163cm |
| <b>BEDROOM 2</b>      | 11'2" x 9'1"  | 342cm x 278cm |
| <b>TERRACE</b>        | 21'2" x 3'7"  | 646cm x 113cm |

- Measurement taken at longest and widest point
- Any areas or measurements are approximate



# APARTMENT 03



## TWO BEDROOM, FIRST FLOOR WITH TERRACE

800 sq ft | 74.3 sq m

|                       |               |               |
|-----------------------|---------------|---------------|
| <b>KITCHEN/LOUNGE</b> | 19'1" x 16'8" | 581cm x 512cm |
| <b>BATHROOM</b>       | 9'5" x 6'3"   | 290cm x 193cm |
| <b>BEDROOM 1</b>      | 14'5" x 9'5"  | 443cm x 290cm |
| <b>EN SUITE</b>       | 7'4" x 4'9"   | 225cm x 150cm |
| <b>BEDROOM 2</b>      | 12'1" x 9'5"  | 368cm x 290cm |
| <b>TERRACE</b>        | 14'2" x 3'6"  | 433cm x 111cm |

- Measurement taken at longest and widest point
- Any areas or measurements are approximate





# APARTMENT 04



## TWO BEDROOM, FIRST FLOOR WITH TERRACE

777 sq ft | 72.2 sq m

|                       |               |               |
|-----------------------|---------------|---------------|
| <b>LOUNGE/KITCHEN</b> | 19'2" x 17'1" | 584cm x 522cm |
| <b>BATHROOM</b>       | 9'2" x 5'4"   | 280cm x 164cm |
| <b>BEDROOM 1</b>      | 14'1" x 9'6"  | 431cm x 292cm |
| <b>ENSUITE</b>        | 8'8" x 4'9"   | 268cm x 150cm |
| <b>BEDROOM 2</b>      | 12'8" x 9'4"  | 389cm x 287cm |
| <b>TERRACE</b>        | 17'6" x 3'6"  | 536cm x 111cm |

- Measurement taken at longest and widest point
- Any areas or measurements are approximate



# APARTMENT 05



## TWO BEDROOM, FIRST FLOOR WITH TERRACE

772 sq ft | 71.8 sq m

|                       |               |               |
|-----------------------|---------------|---------------|
| <b>LOUNGE/KITCHEN</b> | 19'2" x 15'6" | 585cm x 477cm |
| <b>BATHROOM</b>       | 8'2" x 6'4"   | 249cm x 194cm |
| <b>BEDROOM 1</b>      | 13'1" x 8'5"  | 400cm x 258cm |
| <b>EN SUITE</b>       | 7'3" x 6'3"   | 222cm x 193cm |
| <b>BEDROOM 2</b>      | 10'6" x 8'4"  | 322cm x 257cm |
| <b>TERRACE</b>        | 16'5" x 4'1"  | 502cm x 125cm |

- Measurement taken at longest and widest point
- Any areas or measurements are approximate





# APARTMENT 06



## TWO BEDROOM, FIRST FLOOR WITH TERRACE

830 sq ft | 77.1 sq m

|                        |               |               |
|------------------------|---------------|---------------|
| <b>LOUNGE/KITCHEN/</b> | 17'5" x 17'4" | 535cm x 532cm |
| <b>BATHROOM</b>        | 7'2" x 6'4"   | 218cm x 196cm |
| <b>BEDROOM 1</b>       | 10'6" x 9'5"  | 312cm x 290cm |
| <b>EN SUITE</b>        | 7'3" x 5'2"   | 222cm x 158cm |
| <b>BEDROOM 2</b>       | 9'5" x 9'6"   | 291cm x 292cm |
| <b>TERRACE</b>         | 15'2" x 4'1"  | 465cm x 125cm |

- Measurement taken at longest and widest point
- Any areas or measurements are approximate



# APARTMENT 07



## TWO BEDROOM, FIRST FLOOR

638 sq ft | 59.3 sq m

|                       |               |               |
|-----------------------|---------------|---------------|
| <b>LOUNGE/KITCHEN</b> | 17'6" x 13'1" | 536cm x 402cm |
| <b>BATHROOM</b>       | 7'5" x 6'4"   | 228cm x 196cm |
| <b>BEDROOM 1</b>      | 12'1" x 10'7" | 369cm x 325cm |
| <b>EN SUITE</b>       | 7'3" x 4'7"   | 222cm x 143cm |
| <b>BEDROOM 2</b>      | 11'1" x 10'8" | 337cm x 329cm |

- Measurement taken at longest and widest point
- Any areas or measurements are approximate





# APARTMENT 08



## TWO BEDROOM, FIRST FLOOR

684 sq ft | 63.6 sq m

|                       |               |               |
|-----------------------|---------------|---------------|
| <b>LOUNGE/KITCHEN</b> | 17'6" x 13'2" | 535cm x 402cm |
| <b>BATHROOM</b>       | 8'0" x 6'6"   | 245cm x 201cm |
| <b>BEDROOM 1</b>      | 11'8" x 11'3" | 358cm x 344cm |
| <b>EN SUITE</b>       | 7'3" x 5'4"   | 224cm x 164cm |
| <b>BEDROOM 2</b>      | 11'4" x 9'5"  | 349cm x 291cm |

- Measurement taken at longest and widest point
- Any areas or measurements are approximate



# APARTMENT 09



## TWO BEDROOM, FIRST FLOOR

727 sq ft | 67.5 sq m

|                       |               |               |
|-----------------------|---------------|---------------|
| <b>KITCHEN/LOUNGE</b> | 18'1" x 16'2" | 552cm x 494cm |
| <b>BATHROOM</b>       | 7'1" x 6'3"   | 216cm x 191cm |
| <b>BEDROOM 1</b>      | 11'9" x 9'4"  | 362cm x 288cm |
| <b>EN SUITE</b>       | 7'1" x 4'7"   | 215cm x 142cm |
| <b>BEDROOM 2</b>      | 12'4" x 9'5"  | 377cm x 288cm |

- Measurement taken at longest and widest point
- Any areas or measurements are approximate





# APARTMENT 10



## TWO BEDROOM, SECOND FLOOR WITH TERRACE

800 sq ft | 74.3 sq m

|                       |               |               |
|-----------------------|---------------|---------------|
| <b>LOUNGE/KITCHEN</b> | 19'1" x 16'8" | 581cm x 512cm |
| <b>BATHROOM</b>       | 9'5" x 6'3"   | 290cm x 193cm |
| <b>BEDROOM 1</b>      | 14'5" x 9'5"  | 443cm x 290cm |
| <b>EN SUITE</b>       | 7'4" x 4'9"   | 225cm x 150cm |
| <b>BEDROOM 2</b>      | 12'1" x 9'5"  | 368cm x 290cm |
| <b>TERRACE</b>        | 14'2" x 3'6"  | 433cm x 111cm |

- Measurement taken at longest and widest point
- Any areas or measurements are approximate



BRIDGE STREET

# APARTMENT 11



## TWO BEDROOM, SECOND FLOOR WITH TERRACE

777 sq ft | 72.2 sq m

|                       |               |               |
|-----------------------|---------------|---------------|
| <b>LOUNGE/KITCHEN</b> | 19'2" x 17'1" | 584cm x 522cm |
| <b>BATHROOM</b>       | 9'2" x 5'4"   | 280cm x 164cm |
| <b>BEDROOM 1</b>      | 14'1" x 9'6"  | 431cm x 292cm |
| <b>EN SUITE</b>       | 8'8" x 4'9"   | 268cm x 150cm |
| <b>BEDROOM 2</b>      | 12'8" x 9'4"  | 389cm x 287cm |
| <b>TERRACE</b>        | 17'6" x 3'6"  | 536cm x 111cm |

- Measurement taken at longest and widest point
- Any areas or measurements are approximate



BRIDGE STREET

# APARTMENT 12



## TWO BEDROOM, SECOND FLOOR WITH TERRACE

772 sq ft | 71.8 sq m

|                       |               |               |
|-----------------------|---------------|---------------|
| <b>LOUNGE/KITCHEN</b> | 19'2" x 15'6" | 584cm x 477cm |
| <b>BATHROOM</b>       | 8'2" x 6'4"   | 249cm x 194cm |
| <b>BEDROOM 1</b>      | 13'1" x 8'5"  | 400cm x 258cm |
| <b>EN SUITE</b>       | 7'3" x 6'3"   | 222cm x 193cm |
| <b>BEDROOM 2</b>      | 10'6" x 8'4"  | 322cm x 257cm |
| <b>BEDROOM 3</b>      | 16'5" x 4'1"  | 502cm x 125cm |

- Measurement taken at longest and widest point
- Any areas or measurements are approximate



BRIDGE STREET

# APARTMENT 13



## TWO BEDROOM, SECOND FLOOR WITH TERRACE

830 sq ft | 77.1 sq m

|                       |               |               |
|-----------------------|---------------|---------------|
| <b>LOUNGE/KITCHEN</b> | 17'5" x 17'4" | 535cm x 532cm |
| <b>BATHROOM</b>       | 7'2" x 6'4"   | 218cm x 196cm |
| <b>BEDROOM 1</b>      | 10'6" x 9'5"  | 312cm x 290cm |
| <b>EN SUITE</b>       | 7'3" x 5'2"   | 222cm x 158cm |
| <b>BEDROOM 2</b>      | 9'5" x 9'6"   | 291cm x 292cm |
| <b>TERRACE</b>        | 15'2" x 4'1"  | 465cm x 125cm |

- Measurement taken at longest and widest point
- Any areas or measurements are approximate



BRIDGE STREET



# APARTMENT 14



## TWO BEDROOM, SECOND FLOOR

638 sq ft | 59.3 sq m

|                       |               |               |
|-----------------------|---------------|---------------|
| <b>LOUNGE/KITCHEN</b> | 17'6" x 13'1" | 536cm x 402cm |
| <b>BATHROOM</b>       | 7'4" x 6'4"   | 228cm x 196cm |
| <b>BEDROOM 1</b>      | 12'1" x 10'7" | 369cm x 325cm |
| <b>EN SUITE</b>       | 7'3" x 4'7"   | 222cm x 143cm |
| <b>BEDROOM 2</b>      | 11'1" x 10'8" | 337cm x 329cm |

- Measurement taken at longest and widest point
- Any areas or measurements are approximate



# APARTMENT 15



## TWO BEDROOM, SECOND FLOOR

684 sq ft | 63.6 sq m

|                       |               |               |
|-----------------------|---------------|---------------|
| <b>LOUNGE/KITCHEN</b> | 17'5" x 13'2" | 535cm x 402cm |
| <b>BATHROOM</b>       | 8'0" x 6'6"   | 245cm x 201cm |
| <b>BEDROOM 1</b>      | 11'8" x 11'3" | 358cm x 344cm |
| <b>EN SUITE</b>       | 7'3" x 5'4"   | 224cm x 164cm |
| <b>BEDROOM 2</b>      | 11'4" x 9'5"  | 349cm x 291cm |

- Measurement taken at longest and widest point
- Any areas or measurements are approximate



# APARTMENT 16



## TWO BEDROOM, SECOND FLOOR

727 sq ft | 67.5 sq m

|                       |               |               |
|-----------------------|---------------|---------------|
| <b>KITCHEN/LOUNGE</b> | 18'1" x 16'2" | 552cm x 494cm |
| <b>BATHROOM</b>       | 7'1" x 6'3"   | 216cm x 191cm |
| <b>BEDROOM 1</b>      | 11'9" x 9'4"  | 362cm x 288cm |
| <b>EN SUITE</b>       | 7'1" x 4'7"   | 215cm x 142cm |
| <b>BEDROOM 2</b>      | 12'4" x 9'5"  | 377cm x 288cm |

- Measurement taken at longest and widest point
- Any areas or measurements are approximate



BRIDGE STREET

# APARTMENT 17



## TWO BEDROOM, THIRD FLOOR WITH TERRACE

800 sq ft | 74.3 sq m

|                       |               |               |
|-----------------------|---------------|---------------|
| <b>KITCHEN/LOUNGE</b> | 19'1" x 16'8" | 581cm x 512cm |
| <b>BATHROOM</b>       | 9'5" x 6'3"   | 290cm x 193cm |
| <b>BEDROOM 1</b>      | 14'5" x 9'5"  | 443cm x 290cm |
| <b>EN SUITE</b>       | 7'4" x 4'9"   | 225cm x 150cm |
| <b>BEDROOM 2</b>      | 12'1" x 9'5"  | 368cm x 290cm |
| <b>TERRACE</b>        | 14'2" x 3'6"  | 433cm x 111cm |

- Measurement taken at longest and widest point
- Any areas or measurements are approximate



BRIDGE STREET



# APARTMENT 18



## TWO BEDROOM, THIRD FLOOR WITH TERRACE

777 sq ft | 72.2 sq m

|                       |               |               |
|-----------------------|---------------|---------------|
| <b>LOUNGE/KITCHEN</b> | 19'2" x 17'1" | 584cm x 522cm |
| <b>BATHROOM</b>       | 9'2" x 5'4"   | 280cm x 164cm |
| <b>BEDROOM 1</b>      | 14'1" x 9'6"  | 431cm x 292cm |
| <b>ENSUITE</b>        | 8'8" x 4'9"   | 268cm x 150cm |
| <b>BEDROOM 2</b>      | 12'8" x 9'4"  | 389cm x 287cm |
| <b>TERRACE</b>        | 17'6" x 3'6"  | 536cm x 111cm |

- Measurement taken at longest and widest point
- Any areas or measurements are approximate



# APARTMENT 19



## TWO BEDROOM, THIRD FLOOR WITH TERRACE

772 sq ft | 71.8 sq m

|                       |               |               |
|-----------------------|---------------|---------------|
| <b>LOUNGE/KITCHEN</b> | 19'2" x 15'6" | 585cm x 477cm |
| <b>BATHROOM</b>       | 8'2" x 6'4"   | 249cm x 194cm |
| <b>BEDROOM 1</b>      | 13'1" x 8'5"  | 400cm x 258cm |
| <b>EN SUITE</b>       | 7'3" x 6'3"   | 222cm x 193cm |
| <b>BEDROOM 2</b>      | 10'6" x 8'4"  | 322cm x 257cm |
| <b>TERRACE</b>        | 16'5" x 4'1"  | 502cm x 125cm |

- Measurement taken at longest and widest point
- Any areas or measurements are approximate



# APARTMENT 20



## TWO BEDROOM, THIRD FLOOR WITH TERRACE

830 sq ft | 77.1 sq m

|                        |               |               |
|------------------------|---------------|---------------|
| <b>LOUNGE/KITCHEN/</b> | 17'5" x 17'4" | 535cm x 532cm |
| <b>BATHROOM</b>        | 7'2" x 6'4"   | 218cm x 196cm |
| <b>BEDROOM 1</b>       | 10'6" x 9'5"  | 312cm x 290cm |
| <b>EN SUITE</b>        | 7'3" x 5'2"   | 222cm x 158cm |
| <b>BEDROOM 2</b>       | 9'5" x 9'6"   | 291cm x 292cm |
| <b>TERRACE</b>         | 15'2" x 4'1"  | 465cm x 125cm |

- Measurement taken at longest and widest point
- Any areas or measurements are approximate



# APARTMENT 21



## TWO BEDROOM, THIRD FLOOR

638 sq ft | 59.3 sq m

|                       |               |               |
|-----------------------|---------------|---------------|
| <b>LOUNGE/KITCHEN</b> | 17'6" x 13'1" | 536cm x 402cm |
| <b>BATHROOM</b>       | 7'5" x 6'4"   | 228cm x 196cm |
| <b>BEDROOM 1</b>      | 12'1" x 10'7" | 369cm x 325cm |
| <b>EN SUITE</b>       | 7'3" x 4'7"   | 222cm x 143cm |
| <b>BEDROOM 2</b>      | 11'1" x 10'8" | 337cm x 329cm |

- Measurement taken at longest and widest point
- Any areas or measurements are approximate





# APARTMENT 22



## TWO BEDROOM, THIRD FLOOR

684 sq ft | 63.6 sq m

|                       |               |               |
|-----------------------|---------------|---------------|
| <b>LOUNGE/KITCHEN</b> | 17'6" x 13'2" | 535cm x 402cm |
| <b>BATHROOM</b>       | 8'0" x 6'6"   | 245cm x 201cm |
| <b>BEDROOM 1</b>      | 11'8" x 11'3" | 358cm x 344cm |
| <b>EN SUITE</b>       | 7'3" x 5'4"   | 224cm x 164cm |
| <b>BEDROOM 2</b>      | 11'4" x 9'5"  | 348cm x 291cm |

- Measurement taken at longest and widest point
- Any areas or measurements are approximate



# APARTMENT 23



## TWO BEDROOM, THIRD FLOOR

727 sq ft | 67.5 sq m

|                       |               |               |
|-----------------------|---------------|---------------|
| <b>LOUNGE/KITCHEN</b> | 18'1" x 16'2" | 552cm x 494cm |
| <b>BATHROOM</b>       | 7'1" x 6'3"   | 216cm x 191cm |
| <b>BEDROOM 1</b>      | 11'9" x 9'4"  | 362cm x 288cm |
| <b>EN SUITE</b>       | 7'1" x 4'7"   | 215cm x 142cm |
| <b>BEDROOM 2</b>      | 12'4" x 9'5"  | 377cm x 288cm |

- Measurement taken at longest and widest point
- Any areas or measurements are approximate



# APARTMENT 24



## TWO BEDROOM, FOURTH FLOOR WITH TERRACE

730 sq ft | 67.9 sq m

|                       |               |               |
|-----------------------|---------------|---------------|
| <b>LOUNGE/KITCHEN</b> | 16'8" x 15'0" | 512cm x 457cm |
| <b>BATHROOM</b>       | 9'5" x 6'3"   | 290cm x 193cm |
| <b>BEDROOM 1</b>      | 14'5" x 9'5"  | 443cm x 290cm |
| <b>EN SUITE</b>       | 7'3" x 4'9"   | 225cm x 150cm |
| <b>BEDROOM 2</b>      | 12'1" x 9'5"  | 368cm x 290cm |
| <b>TERRACE</b>        | 16'5" x 2'10" | 504cm x 90cm  |

- Measurement taken at longest and widest point
- Any areas or measurements are approximate



# APARTMENT 25



## TWO BEDROOM, FOURTH FLOOR WITH TERRACE

777 sq ft | 72.2 sq m

|                       |               |               |
|-----------------------|---------------|---------------|
| <b>LOUNGE/KITCHEN</b> | 19'2" x 17'1" | 584cm x 522cm |
| <b>BATHROOM</b>       | 9'2" x 5'4"   | 280cm x 164cm |
| <b>BEDROOM 1</b>      | 14'1" x 9'6"  | 431cm x 292cm |
| <b>EN SUITE</b>       | 8'8" x 4'9"   | 268cm x 150cm |
| <b>BEDROOM 2</b>      | 12'8" x 9'4"  | 389cm x 287cm |
| <b>TERRACE</b>        | 17'8" x 3'9"  | 544cm x 118cm |

- Measurement taken at longest and widest point
- Any areas or measurements are approximate





# APARTMENT 26



## TWO BEDROOM, FOURTH FLOOR WITH TERRACE

772 sq ft | 71.8 sq m

|                       |               |               |
|-----------------------|---------------|---------------|
| <b>LOUNGE/KITCHEN</b> | 19'2" x 15'6" | 585cm x 477cm |
| <b>BATHROOM</b>       | 8'2" x 6'4"   | 249cm x 194cm |
| <b>BEDROOM 1</b>      | 13'1" x 8'4"  | 400cm x 258cm |
| <b>EN SUITE</b>       | 7'3" x 6'3"   | 222cm x 193cm |
| <b>BEDROOM 2</b>      | 10'6" x 8'4"  | 322cm x 257cm |
| <b>TERRACE</b>        | 16'5" x 4'1"  | 502cm x 125cm |

- Measurement taken at longest and widest point
- Any areas or measurements are approximate



# APARTMENT 27



## TWO BEDROOM, FOURTH FLOOR WITH TERRACE

836 sq ft | 77.7 sq m

|                       |               |               |
|-----------------------|---------------|---------------|
| <b>LOUNGE/KITCHEN</b> | 17'5" x 17'4" | 535cm x 532cm |
| <b>BATHROOM</b>       | 7'2" x 6'4"   | 218cm x 196cm |
| <b>BEDROOM 1</b>      | 10'6" x 9'5"  | 312cm x 290cm |
| <b>EN SUITE</b>       | 7'3" x 5'2"   | 222cm x 158cm |
| <b>BEDROOM 2</b>      | 9'6" x 9'6"   | 291cm x 292cm |
| <b>TERRACE</b>        | 15'2" x 4'1"  | 465cm x 125cm |

- Measurement taken at longest and widest point
- Any areas or measurements are approximate



# APARTMENT 28



## TWO BEDROOM, FOURTH FLOOR

638 sq ft | 59.3 sq m

|                       |               |               |
|-----------------------|---------------|---------------|
| <b>LOUNGE/KITCHEN</b> | 17'6" x 13'1" | 536cm x 402cm |
| <b>BATHROOM</b>       | 7'5" x 6'4"   | 228cm x 196cm |
| <b>BEDROOM 1</b>      | 12'1" x 10'7" | 369cm x 325cm |
| <b>EN SUITE</b>       | 7'3" x 4'7"   | 222cm x 143cm |
| <b>BEDROOM 2</b>      | 11'1" x 10'8" | 337cm x 329cm |

- Measurement taken at longest and widest point
- Any areas or measurements are approximate



# APARTMENT 29



## TWO BEDROOM, FOURTH FLOOR

684 sq ft | 63.6 sq m

|                       |               |               |
|-----------------------|---------------|---------------|
| <b>LOUNGE/KITCHEN</b> | 17'6" x 13'1" | 535cm x 402cm |
| <b>BATHROOM</b>       | 8'0" x 6'6"   | 245cm x 201cm |
| <b>BEDROOM 1</b>      | 11'8" x 11'3" | 358cm x 344cm |
| <b>EN SUITE</b>       | 7'3" x 5'4"   | 224cm x 164cm |
| <b>BEDROOM 2</b>      | 11'4" x 9'5"  | 349cm x 291cm |

- Measurement taken at longest and widest point
- Any areas or measurements are approximate





# APARTMENT 30



## TWO BEDROOM, FOURTH FLOOR

727 sq ft | 67.5 sq m

|                       |               |               |
|-----------------------|---------------|---------------|
| <b>LOUNGE/KITCHEN</b> | 18'1" x 16'2" | 552cm x 494cm |
| <b>BATHROOM</b>       | 7'1" x 6'3"   | 216cm x 191cm |
| <b>BEDROOM 1</b>      | 11'9" x 9'4"  | 362cm x 288cm |
| <b>EN SUITE</b>       | 7'1" x 4'7"   | 215cm x 142cm |
| <b>BEDROOM 2</b>      | 12'4" x 9'5"  | 377cm x 288cm |

- Measurement taken at longest and widest point
- Any areas or measurements are approximate



# APARTMENT 31



## THREE BEDROOM, FIFTH FLOOR WITH TERRACE

1350 sq ft | 125.5 sq m

|                      |               |                |
|----------------------|---------------|----------------|
| <b>LOUNGE/DINING</b> | 21'7" x 20'1" | 661cm x 614cm  |
| <b>KITCHEN</b>       | 12'8" x 7'5"  | 391cm x 231cm  |
| <b>BATHROOM</b>      | 9'2" x 6'3"   | 283cm x 191cm  |
| <b>BEDROOM 1</b>     | 18'3" x 15'3" | 558cm x 467cm  |
| <b>EN SUITE</b>      | 9'3" x 6'2"   | 283cm x 188cm  |
| <b>BEDROOM 2</b>     | 13'0" x 9'7"  | 397cm x 295cm  |
| <b>ENSUITE</b>       | 9'6" x 4'7"   | 293cm x 142cm  |
| <b>BEDROOM 3</b>     | 13'0" x 12'6" | 397cm x 383cm  |
| <b>TERRACE</b>       | 30'5" x 16'8" | 929cm x 514cm  |
| <b>TERRACE</b>       | 51'7" x 3'3"  | 1572cm x 102cm |

- Measurement taken at longest and widest point
- Any areas or measurements are approximate



# APARTMENT 32



## THREE BEDROOM, FIFTH FLOOR WITH TERRACE

1310 sq ft | 121.7 sq m

|                       |               |               |
|-----------------------|---------------|---------------|
| <b>LOUNGE/KITCHEN</b> | 24'1" x 20'3" | 735cm x 619cm |
| <b>BATHROOM</b>       | 9'5" x 7'2"   | 290cm x 220cm |
| <b>BEDROOM 1</b>      | 16'4" x 13'7" | 502cm x 417cm |
| <b>EN SUITE</b>       | 9'7" x 5'3"   | 296cm x 163cm |
| <b>BEDROOM 2</b>      | 13'1" x 12'4" | 400cm x 379cm |
| <b>BEDROOM 3</b>      | 9'7" x 9'5"   | 294cm x 290cm |
| <b>TERRACE</b>        | 31'9" x 4'1"  | 973cm x 125cm |
| <b>TERRACE</b>        | 9'6" x 3'3"   | 292cm x 102cm |

- Measurement taken at longest and widest point
- Any areas or measurements are approximate



# APARTMENT 33



## TWO BEDROOM, FIFTH FLOOR WITH TERRACE

944 sq ft | 87.7 sq m

|                      |               |               |
|----------------------|---------------|---------------|
| <b>LOUNGE/DINING</b> | 24'1" x 15'2" | 737cm x 463cm |
| <b>KITCHEN</b>       | 13'5" x 8'6"  | 413cm x 263cm |
| <b>BATHROOM</b>      | 9'6" x 6'4"   | 293cm x 195cm |
| <b>BEDROOM 1</b>     | 13'4" x 9'2"  | 408cm x 280cm |
| <b>ENSUITE</b>       | 7'5" x 6'5"   | 230cm x 198cm |
| <b>BEDROOM 2</b>     | 12'6" x 9'7"  | 385cm x 295cm |
| <b>TERRACE</b>       | 24'1" x 3'3"  | 737cm x 102cm |

- Measurement taken at longest and widest point
- Any areas or measurements are approximate





# APARTMENT 34



## THREE BEDROOM, FIFTH FLOOR WITH TERRACE

1040 sq ft | 96.7 sq m

|               |                     |                                     |
|---------------|---------------------|-------------------------------------|
| LOUNGE/DINING | 17'1" x 15'7"       | 520cm x 480cm                       |
| KITCHEN       | 9'5" x 9'3"         | 289cm x 285cm                       |
| BATHROOM      | 9'4" x 6'3"         | 285cm x 192cm                       |
| BEDROOM 1     | 13'7" x 10'1"       | 418cm x 309cm                       |
| ENSUITE       | 9'4" x 8'2"         | 288cm x 251cm                       |
| BEDROOM 2     | 13'0" x 9'4"        | 398cm x 285cm                       |
| BEDROOM 3     | 13'7" x 9'0"        | 418cm x 275cm                       |
| TERRACE       | 42'0" x 3'3" x 6'1" | 1283cm x 102cm<br>(widens to 186cm) |

- Measurement taken at longest and widest point
- Any areas or measurements are approximate



# THE MILLHOUSE LOCATION





N I X O N B L U E